

AC6305**AC6310***Compact in various circuit configurations***Description**

A slip ring can be used in any electromechanical system that requires unrestrained, continuous rotation while transferring power and / or data from a stationary to a rotating structure. A slip ring is also called a rotary electrical interface, commutator, collector, swivel or an electrical rotary joint.

The AC6305 provides three, 5 amp circuits combined with 6, 9, or 12 signal (2 amp max) circuits. The AC6310 provides three, 10 amp circuits and 3 or 6 signal circuits. This compact power and signal handling design provides unique capability for many challenging applications.

Features

- 6, 9, 12 and 15 circuit models
- 5 amp / 2 amp and 10 amp / 2 amp circuit combinations
- Precision ball bearings meet or exceed life requirements for most commercial applications
- Speeds up to 250 rpm
- Compact size: 1.38 inch long
- Gold
- 12, 24, 36, 48 inch standard lead lengths (longer lead lengths are available)
- Sealed units are also available (dust and light splash only)
- Flexible silver-plated copper, color-coded, Teflon® insulated lead wires
- Compatible with data bus protocols
- Also available with 6, 12, 18, and 24, 2 amp rings. Please refer to AC6023 data sheet.

Benefits

- Smooth running
- Low torque
- Compact
- Very low noise (electrical)
- Quick shipment

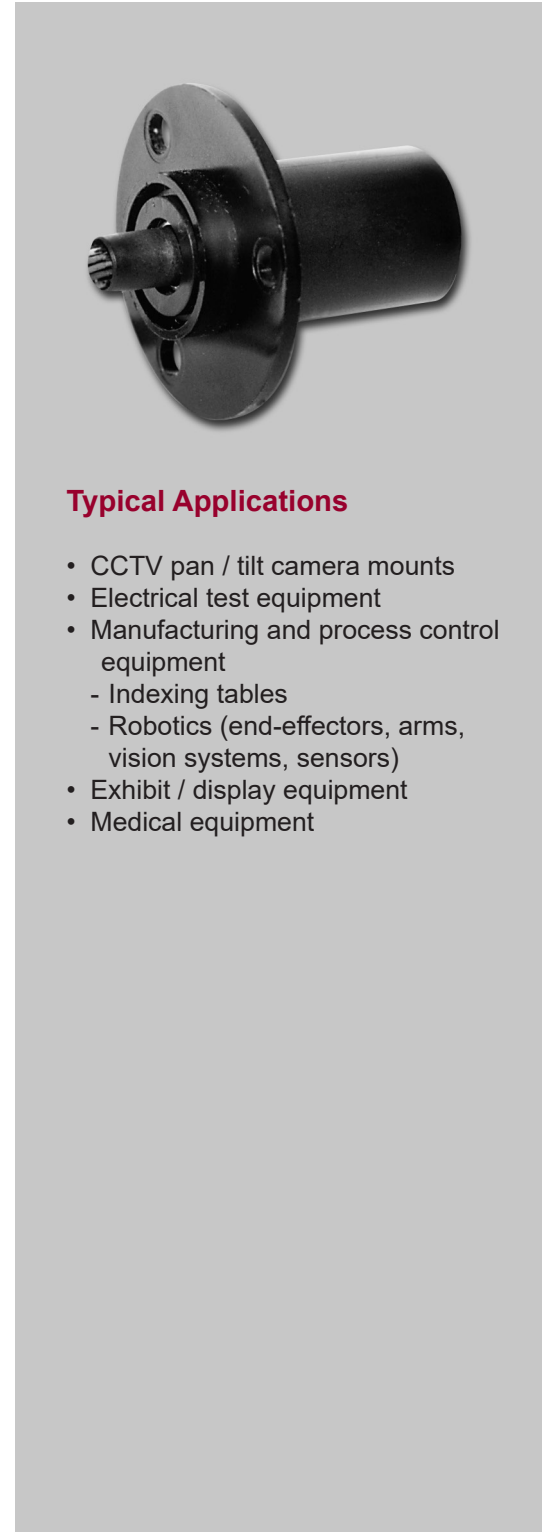
**Typical Applications**

- CCTV pan / tilt camera mounts
- Electrical test equipment
- Manufacturing and process control equipment
 - Indexing tables
 - Robotics (end-effectors, arms, vision systems, sensors)
- Exhibit / display equipment
- Medical equipment

Specifications	AC6305	AC6310	Options
Operating Speed	250 rpm*	250 rpm*	<ul style="list-style-type: none"> Splash seals for dust and moisture resistance Metal housings with and without flanges
Number of Circuits	3 @ 5 amps and 6, 9, or 12 @ 2 amps	3 @ 10 amps and 3 or 6 @ 2 amps	
Lead Lengths	12, 24, 36 and 48 inches	12, 24, 36 and 48 inches	
Lead Size / Type	2 amp, 26 gauge silver plated copper, Teflon® 5 amp, 20 gauge silver plated copper, Teflon®	2 amp, 26 gauge silver plated copper, Teflon® 10 amp, 16 gauge tin plated copper, Teflon®	
Voltage	240 VAC	240 VAC	
Max Ambient Temp.	-40°C to +80°C	-40°C to +80°C	
Contact Material	Gold	Gold	
Current Rating	5 amps and 2 amps / circuit	10 amps and 2 amps / circuit	
Noise	60 milliohms max.	60 milliohms max.	

*Please note that the operational life of the unit is dependent upon rotational speed, environment and temperature.

AC6305 Lead Wire Color Codes					AC6310 Lead Wire Color Codes				
	Ring #	Color Code	Ring #	Color Code		Ring #	Color Code	Ring #	Color Code
20 AWG TAGGED LEADS	1	BLK	9	GRN	16 AWG TAGGED LEADS	1	BLK	9	GRN
	2	BLK	10	BLU		2	BLK		
	3	BLK	11	VIO		3	BLK		
	4	BLK	12	GRY		4	BLK		
	5	BRN	13	WHT		5	BRN		
	6	RED	14	WHT-BLK		6	RED		
	7	ORN	15	WHT-BRN		7	ORN		
	8	YEL				8	YEL		

AC6305 / AC6310 Dimensions

Part Number	"A"
AC6305 / AC6310	12 in (304.8 mm)
AC6305-A / AC6310-A	24 in (609.6 mm)
AC6305-B / AC6310-B	36 in (914.4 mm)
AC6305-C / AC6310-C	48 in (1219.2 mm)

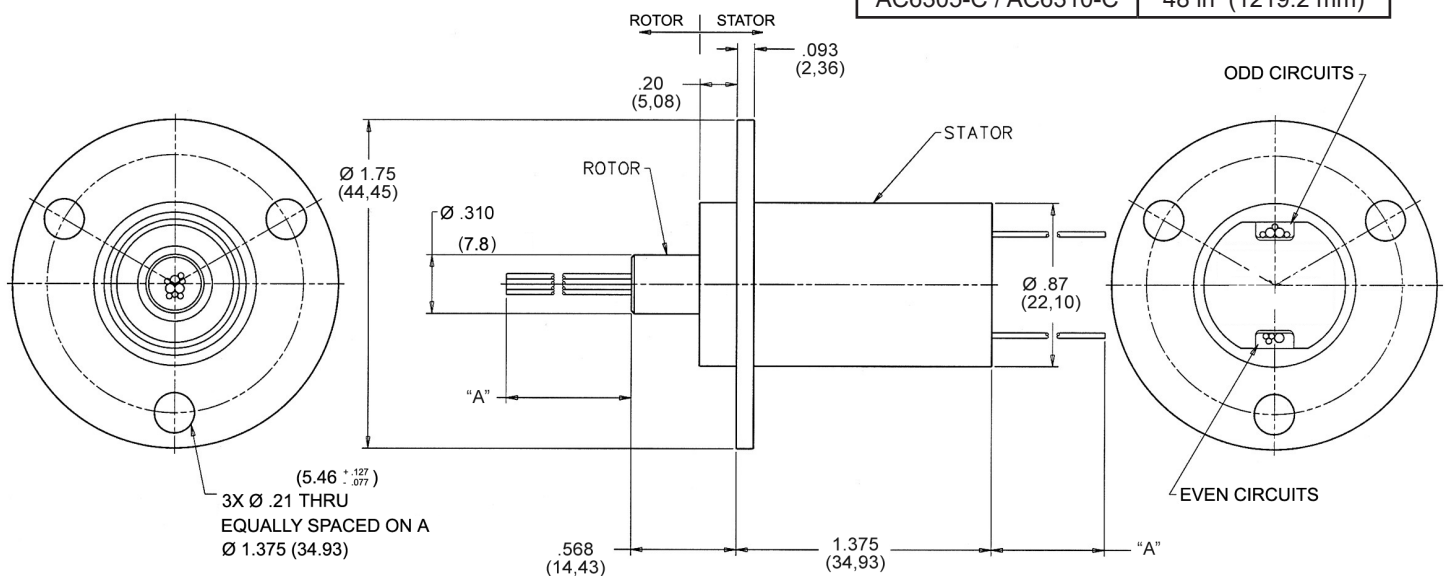

Dimensions in inches (millimeters)

AC7551 Specifications (IP 65 Sealed Versions of AC6023, AC6305/AC6310, AC7188, & AC7203)		Options
Operating Speed	250 rpm	<ul style="list-style-type: none"> • No Flange • 12, 24, 36, or 48 Inch Leads • See data sheets for standard circuit options <ul style="list-style-type: none"> - AC6023 - AC6305/AC6310 - AC7188 - AC7203 • Custom wiring configurations can be quoted
Current Rating	2A, 5A, 10A	
Voltage	240 VAC / VDC	
Contact Material	Gold-on-gold	
Temperature Range	-40°C to +80°C	
Electrical Noise	60 milliohms max.	
Video Connections	HD-SDI	
Ethernet Connections	10/100BaseT and 1000BaseT	

AC7551 Dimensions

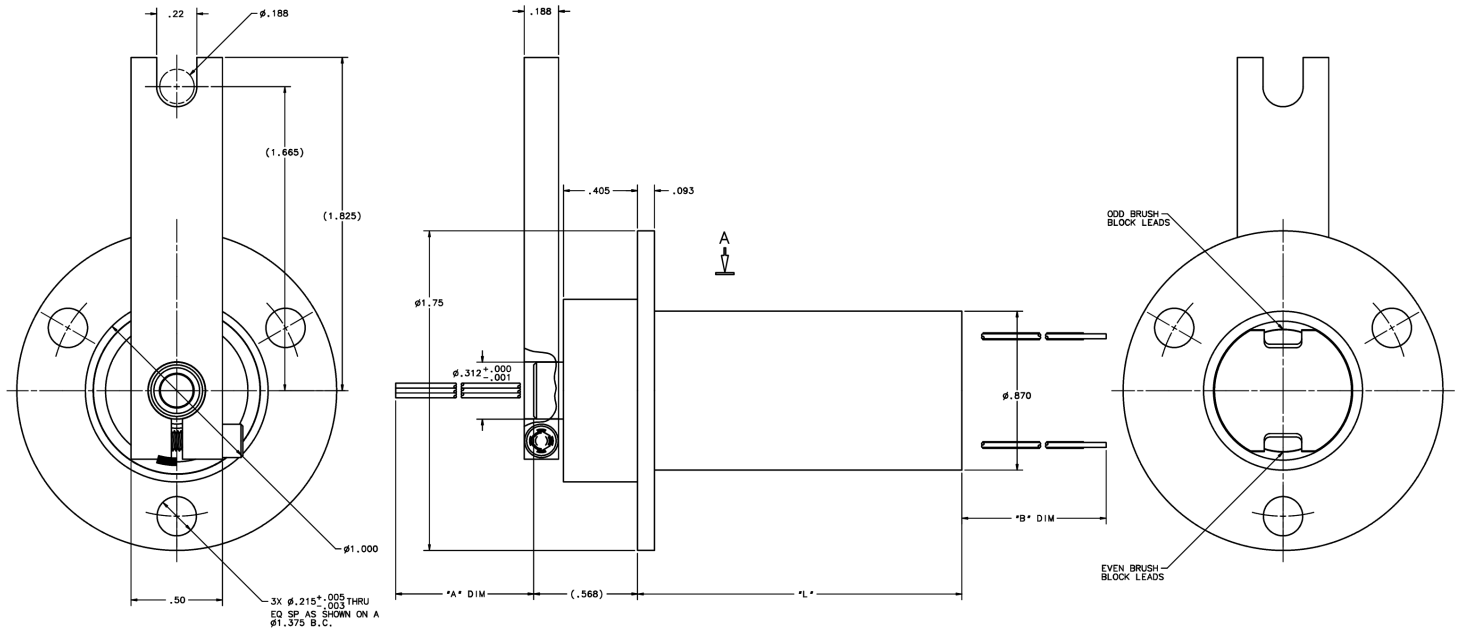

Dimensions in inches

Part Number	Capsule Length (L)
AC7551-6	.965 in
AC7551-12	1.235 in
AC7551-18	1.505 in
AC7551-24	1.775 in

Dash Number	Dim "A"	Dim "B"
AC7551-*	12.0 in minimum	11.5 in minimum
AC7551-*A	24.0 in minimum	23.5 in minimum
AC7551-*B	36.0 in minimum	35.5 in minimum
AC7551-*C	48.0 in minimum	47.5 in minimum